

# ADVARIO

Terminal Factsheet

# Advorio Terminals LLC



## TERMINAL FACTS

### Tank Capacity

1,294,780 cbm | 8,143,921 bbl

### Tanks

66

### Tank Types

Mild steel tank, coated steel tank, Spherical tank

### Tank Sizes

1,700 - 55,000 cbm | 10,692 to 345,940 bbl

### Jetty Capacities

140,000 dwt

### Access Types

Barge, Flexi Bag, ISO Container, Pipeline, Tank-to-Tank, Tanker Trucks, Vessel

### Draught

15.5 m | 50.85 ft

### Berths

6

### Products

Clean Petroleum Products, Petrochemicals, Gases

### Services

Additivation, Blending, Barge loading & unloading, Bonded warehouse storage, Connection to long-distance pipelines, Drum storage warehouse, Homogenizing, Independent lab on-site, Inter-terminal transfer, Nitrogen supply, Ship to Ship transfer, Tank-to-tank transfer, Truck & Iso Container loading & unloading, Vessel loading & unloading

## TERMINAL CONTACT

### Advario Terminals LLC

Sohar Industrial Port  
P. O. Box 369  
Falaj Al Qubail, PC 322

 +968 26 700300



 commercial.oman@advario.com

 <https://advario.com>

## MARKETING CONTACT

### MANAGERS

Commercial Manager: Deepak Bhatia  
deepak.bhatia@advario.com

Terminal Manager: Bahjat Tuffaha  
bahjat.tuffaha@advario.com

 commercial.oman@advario.com

**AREA MAP**

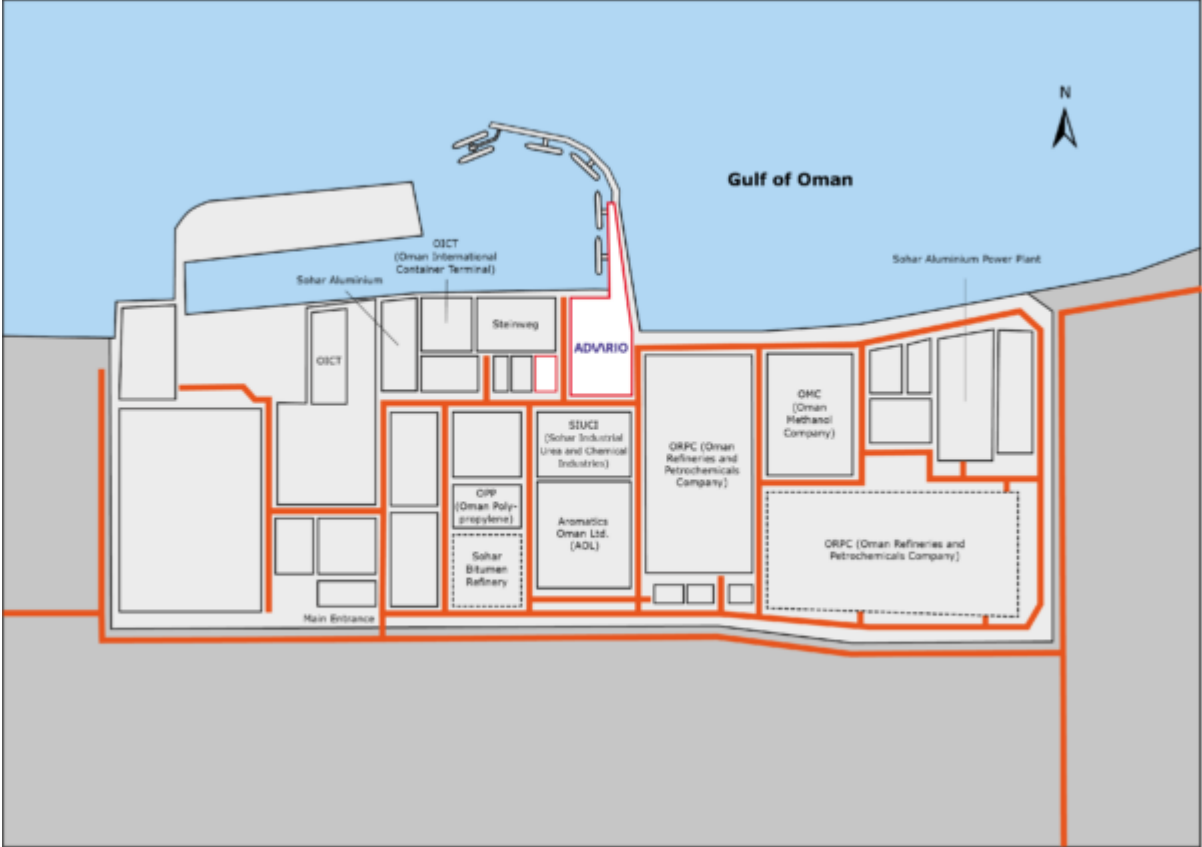

## SITE MAP

